



# FIRE STATION 34



The second largest city in Northern Kentucky, the City of Florence’s population growth in recent years has driven a demand for additional fire personnel and a new headquarter station to house them.

The Florence Fire Department approached this new station with a commitment to the health, readiness, and professional development of its firefighters. As such, the fire station incorporates decontamination spaces, areas for advanced training, and support spaces for both physical and mental well-being.

The station design includes elements of clean lines, simple massing, single-sloped roofs, and materials that support a contemporary and timeless aesthetic.

KZF Design provided project management, architecture, MEP, structural engineering, and interior design services.

**PROJECT STATS**

**Size:** 20,500 SF  
**Construction Cost:** \$10.2 M  
**Complete:** 2025

## FLOOR PLAN



- A - HOT (RED) ZONE**
  - 1 APPARATUS BAY
- B - TRANSITION (YELLOW) ZONE**
  - 2 DECONTAMINATION
  - 3 PERSONNEL DECONTAMINATION
  - 4 DECONTAMINATION SHOWER
  - 5 REPORT
  - 6 EMS
  - 7 EMS STORAGE
  - 8 TURNOUT GEAR STORAGE
  - 9 SHOP
  - 10 SCUBA/TOOL ROOM
  - 11 TRAINING TOWER/STAIR
- C - COLD (GREEN) ZONE**
  - 12 FITNESS ROOM
  - 13 DORM
  - 14 OFFICE
  - 15 PRIVATE SHOWER/TOILET
  - 16 LAUNDRY
  - 17 DAY ROOM
  - 18 KITCHEN/DINING
  - 19 PATIO
- D - ADMINISTRATIVE (BLUE) ZONE**
  - 20 FILE STORAGE
  - 21 EMS OFFICE
  - 22 MARSHAL OFFICE
  - 23 TRAINING OFFICE
  - 24 CONFERENCE ROOM
  - 25 BREAK ROOM
  - 26 CHIEF OFFICE
  - 27 COPY ROOM
  - 28 TOILET
  - 29 OFFICE
  - 30 ADMIN ASSISTANCE
  - 31 TRAINING STORAGE
- E - PUBLIC (PURPLE) ZONE**
  - 32 LOBBY
  - 33 TRAINING
  - 33 TOILET

## SITE PLAN

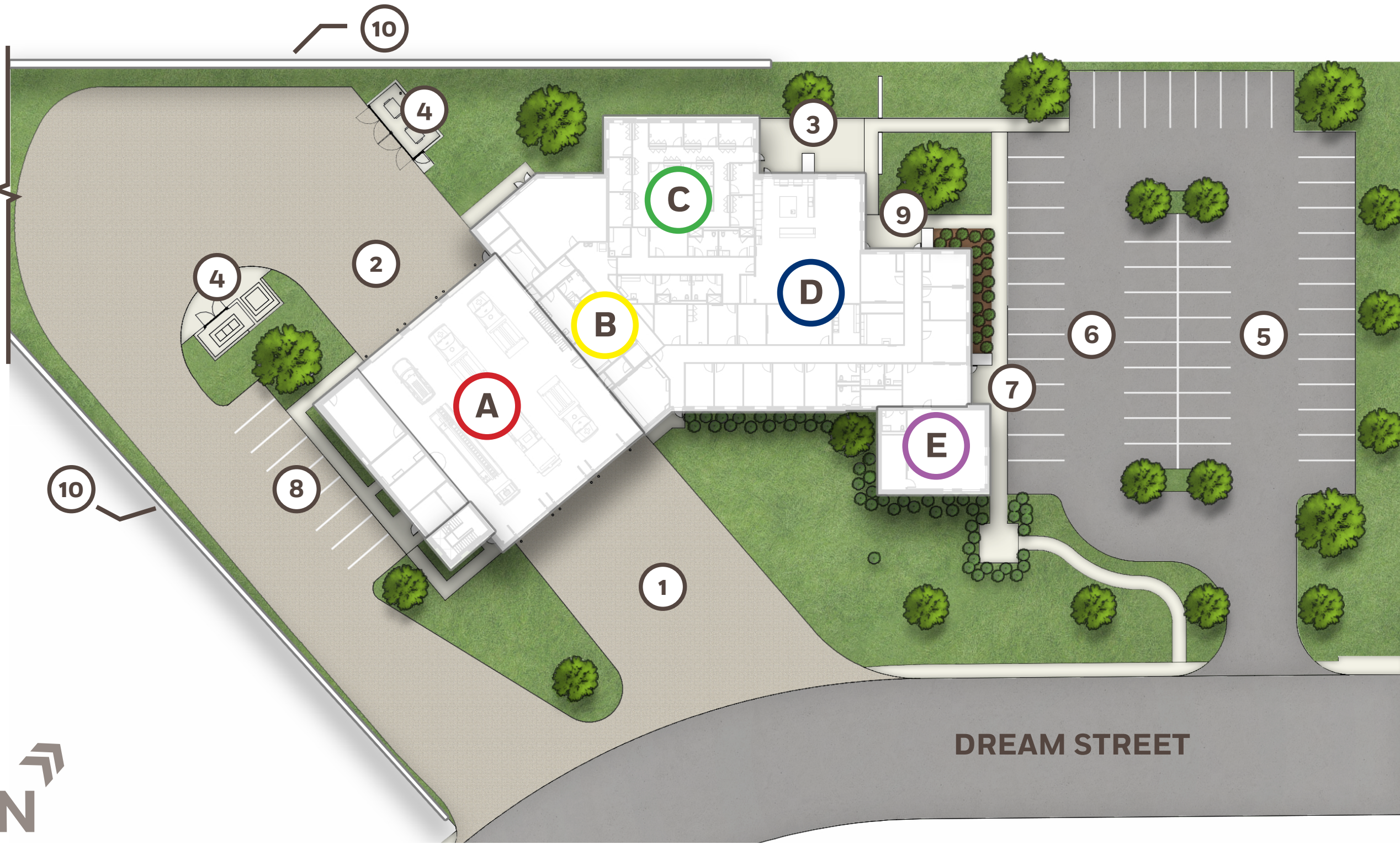

- SITE PLAN LEGEND**
- 1 FRONT APRON
  - 2 REAR APRON
  - 3 EXTERIOR REC/FITNESS PATIO
  - 4 GENERATOR/DUMPSTER ENCLOSURE
  - 5 PUBLIC PARKING
  - 6 ADMIN STAFF PARKING
  - 7 PUBLIC ENTRANCE
  - 8 FIREFIGHTER PARKING
  - 9 ADMIN STAFF ENTRANCE
  - 10 SITE RETAINING WALL

The non-traditional boomerang floor plan was developed out of challenges stemming from the site’s location in the urban core, with the topography requiring retaining walls and careful planning. While the location is ideal for the Fire Department due to its proximity to the City’s Government Center, the design team had to implement creative solutions to manage site challenges and maximize the building floor plan within a constrained site with limited access points.



SITE ACCESS

The site layout establishes clear and distinct areas for emergency vehicles versus public access, which is remote from the return lane and rear apron for emergency vehicles. The public entrance is clearly defined through hardscaping, landscaping, signage, and material finishes. Private staff entrances are located in the rear of the station.



TRAINING SPACES

Station 34's training room is designed with state-of-the-art AV systems that allow for both in-person and virtual instruction. Modular furniture and flexible layouts ensure that the room can accommodate a wide variety of scenarios and class sizes.

There are also opportunities for practical training with an apparatus bay engineered not only for efficient vehicle storage but also as a tactical training area. The adjoining training tower is designed for multi-story drills, complete with a mezzanine to perform ladder operations at simulated door and window openings, and integrated anchor points for rope training. Nearby, a confined space simulation offers a safe, controlled environment for horizontal and vertical rescue drills.



HEALTH & WELLNESS



Decontamination Zone

To address growing concerns over carcinogen exposure, Station 34 was meticulously planned with clearly delineated Hot, Warm, and Cold zones. This setup and flow from one zone to the next reduces cross-contamination through dedicated spaces for specifically designed for gear cleaning, personnel decontamination areas, as well as providing both physical and mechanical separation.

Centrally located with direct access from both the administrative and operational wings, the fitness center design ensures that firefighters can easily transition between physical training and active duty. Equipped with a comprehensive range of cardio, strength, and functional training equipment, the facility features high ceilings for optimal airflow and adequate space for high-intensity workouts. This space is designed not just for physical fitness, but for mental recovery, with a direct connection to the outdoors through a pair of doors and large windows which allow natural light to flood the space, contributing to the overall wellness of personnel.



Fitness Center



Day Room & Kitchen



Outdoor Patio

The day room and kitchen area are also critical components of firefighter wellness. Featuring an open-concept layout, the space is furnished with durable, easy-to-clean surfaces and commercial-grade appliances to withstand the high demands of station life. Natural light fills the space with floor-to-ceiling windows, and the implementation of natural materials enhances a biophilic design to improve wellness. With ample seating for all on-shift personnel, this space fosters camaraderie and rest between calls.

The design incorporates a direct connection to an outdoor patio, encouraging firefighters to spend time outdoors for relaxation or informal team gatherings, providing an essential balance between work and recovery.

