

# SALEM FIRE AND EMS STATION 151

Salem Fire and EMS Station 151 Data

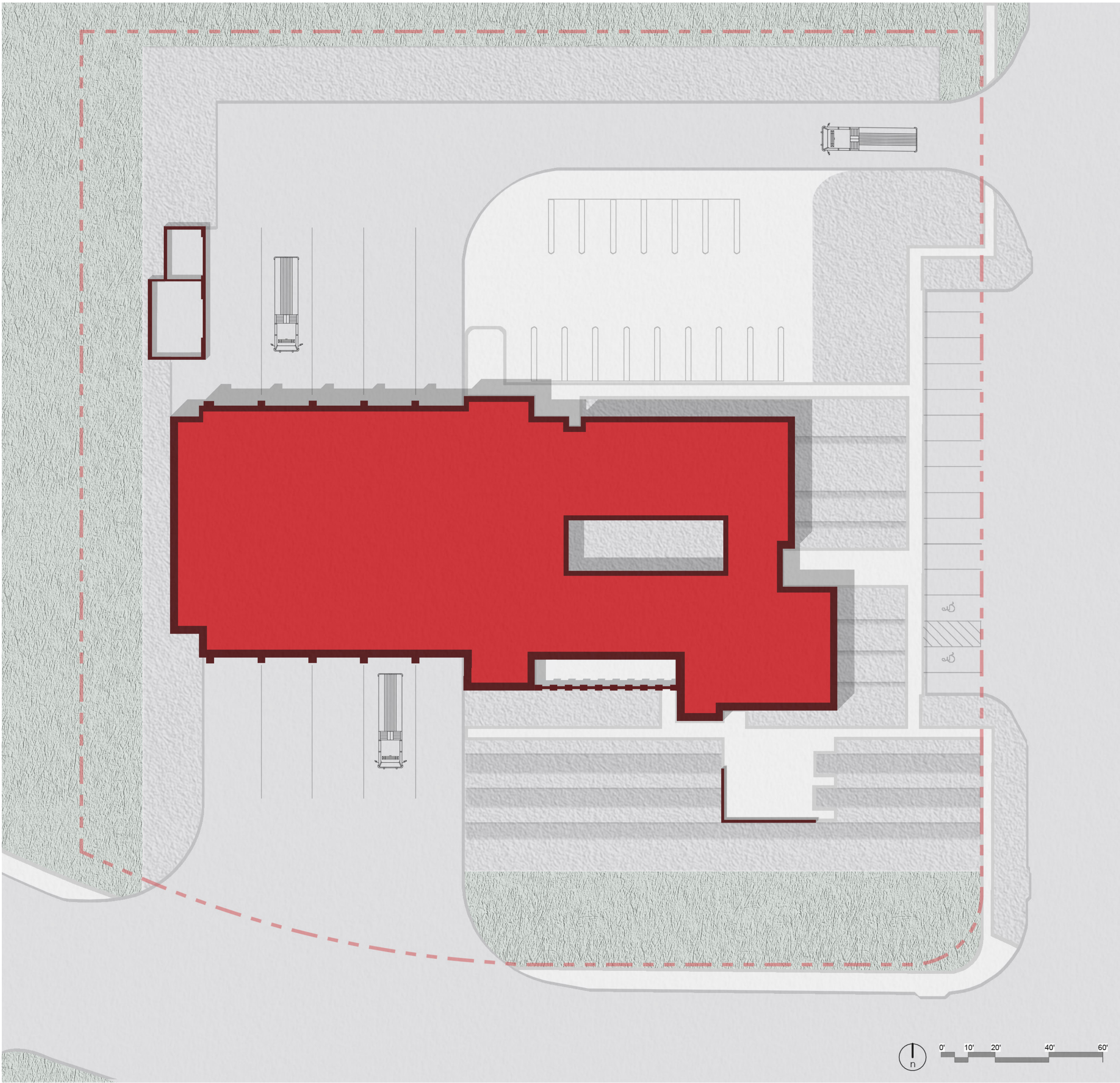

Project Name	Salem Fire and EMS Station 151
Fire Agency Name	Salem Fire Department
Fire Agency Type	Municipal
Project Location (City/County/State)	Salem City, Utah County, Utah
Architect of Record	ajc architects
General Contractor	Warner & Associates Construction
Site Size	2.33 acres
Building Square Footage	21,777 SF (Gross)
Actual Cost for Building and Site Improvements	\$10,989,498
Completion Month and Year	April 2025
Size of Typical Duty Crew	10 individuals
Crew Capacity	10 individuals
Number of Bays	5 bays
Number of Sleeping Units	6 dorm units
Principal Structure Type	Steel & Heavy Timber
Principal Exterior Building Materials	Masonry, concrete, metal panel, masonry screen wall, Accoya rain and solar screens
Principal Interior Building Materials	Metal stud, gypsum board, and timber trusses
Green Initiatives	The fire station site features a xeriscaped landscape design with low-water use plantings and rock mulch that replaces areas normally dedicated to grass. The building itself utilizes a Variable Air Volume (VAV) HVAC system for optimal zoning and energy efficiency within the various interior spaces. Large roof overhangs, high-performance glazing, and a tight building envelope mitigate solar gain. The heavy timber structure is not only a nod to regional design but a renewable material choice with low embodied carbon.



**Health, Safety and Wellness Initiatives**

The design of Station No. 151 prioritizes the health and wellness of firefighters and EMS personnel through a combination of strategic planning, thoughtful materials, and day-to-day comfort considerations. Individual sleeping quarters reduce noise and support proper rest cycles, while the kitchen, fitness area, and dayroom are organized for easy socialization and decompression. A VAV mechanical system ensures zoned climate control throughout the building, supporting individualized comfort in both active and rest areas. Views toward the Wasatch Front and two private interior courtyards provide biophilic benefits. The timber truss structure and natural materials bring warmth and calm to the interior environment.





Salem Fire and EMS Station 151

