



EDSALL ROAD FIRE STATION #26

SPRINGFIELD, VA



ARCHITECT
CONTRACTOR
FIRE AGENCY
LOCATION

Samaha Associates, PC
Carlson Bros, Inc.
Fairfax County Fire & Rescue
Springfield, Virginia

SITE SIZE	1.49 Acres
BUILDING SIZE	14,130 SF
TOTAL COST	\$8,633,321
DRIVE-THROUGH BAYS	4
PERSONNEL PER SHIFT	13

EXISTING STATION



It was a unique opportunity to revive a fire station our team first designed fifty years ago. The modest 8,300 SF original station was from an era when firefighting and emergency medical services personnel operated as independent companies, sharing centrally-located administrative and living spaces within the core of the station with the bays for each apparatus pushed to opposite sides of the building.



At the southern end of the Capital Beltway in the suburbs of Washington, DC is an area of freeway called the Springfield Interchange, otherwise referred to as “The Mixing Bowl”. The I-95, I-495, I-395, and local exits converge in a commingling of lanes, flyovers, and ramps to create an interchange that has been one of the most highly concentrated areas of traffic incidents in the nation for decades. The Springfield Interchange falls under the response area of the Edsall Road Fire Station.



During design, an apparatus parked inside one of the bays caught fire and destroyed a portion of the existing building. The firewall designed over 50 years ago contained the spread of fire, but now the need for a new space was greater than ever.



The critical path in the project involved constructing a temporary fire station consisting of a triple-wide trailer living space and frame supported membrane structure apparatus bay on an adjacent site leased from a neighboring concrete plant. Once the temporary facilities were operational, the team was able to complete the renovation and addition on the tight 1.49-acre site faster than an occupied phased renovation could have been performed.



EDSALL ROAD FIRE STATION #26

SPRINGFIELD, VA

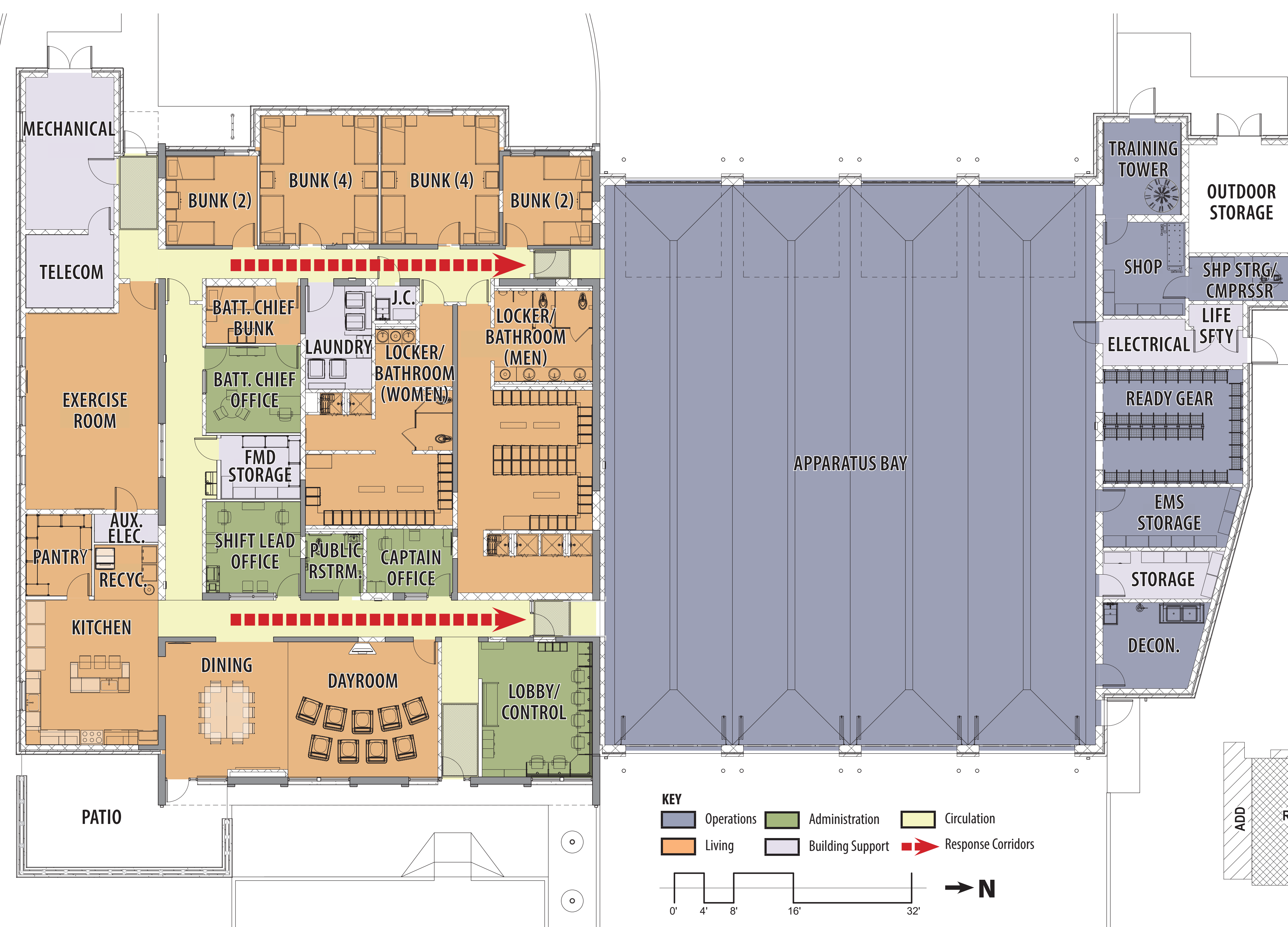

The station is organized around two response corridors that enter the front and back of the apparatus bay, allowing for quick and direct response from anywhere in the station. Administrative functions are located at the front of the building facing the street, with the more private residential functions including bunk rooms along the back of the building facing the staff parking.

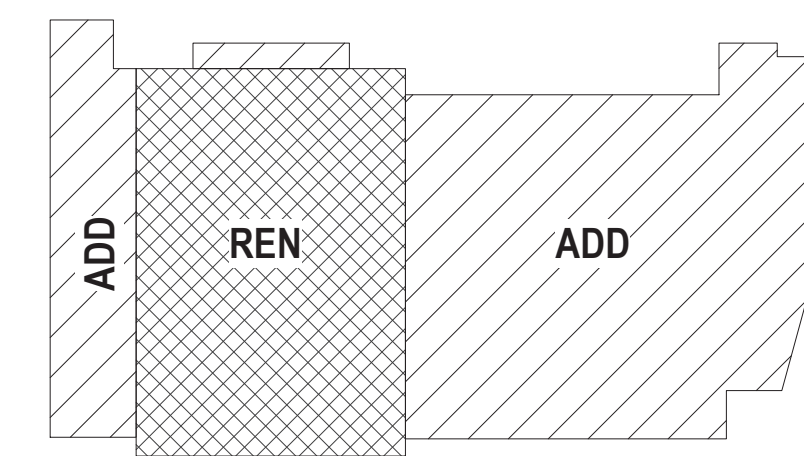

RENOVATION : 5,180 SF
ADDITION : 8,950 SF
TOTAL : 14,130 SF



The modernized design solution involved expanding the existing facility to 14,130 SF, providing four drive-through 76-foot deep bays and accommodating three shifts of 13 career staff within a rapid response layout.

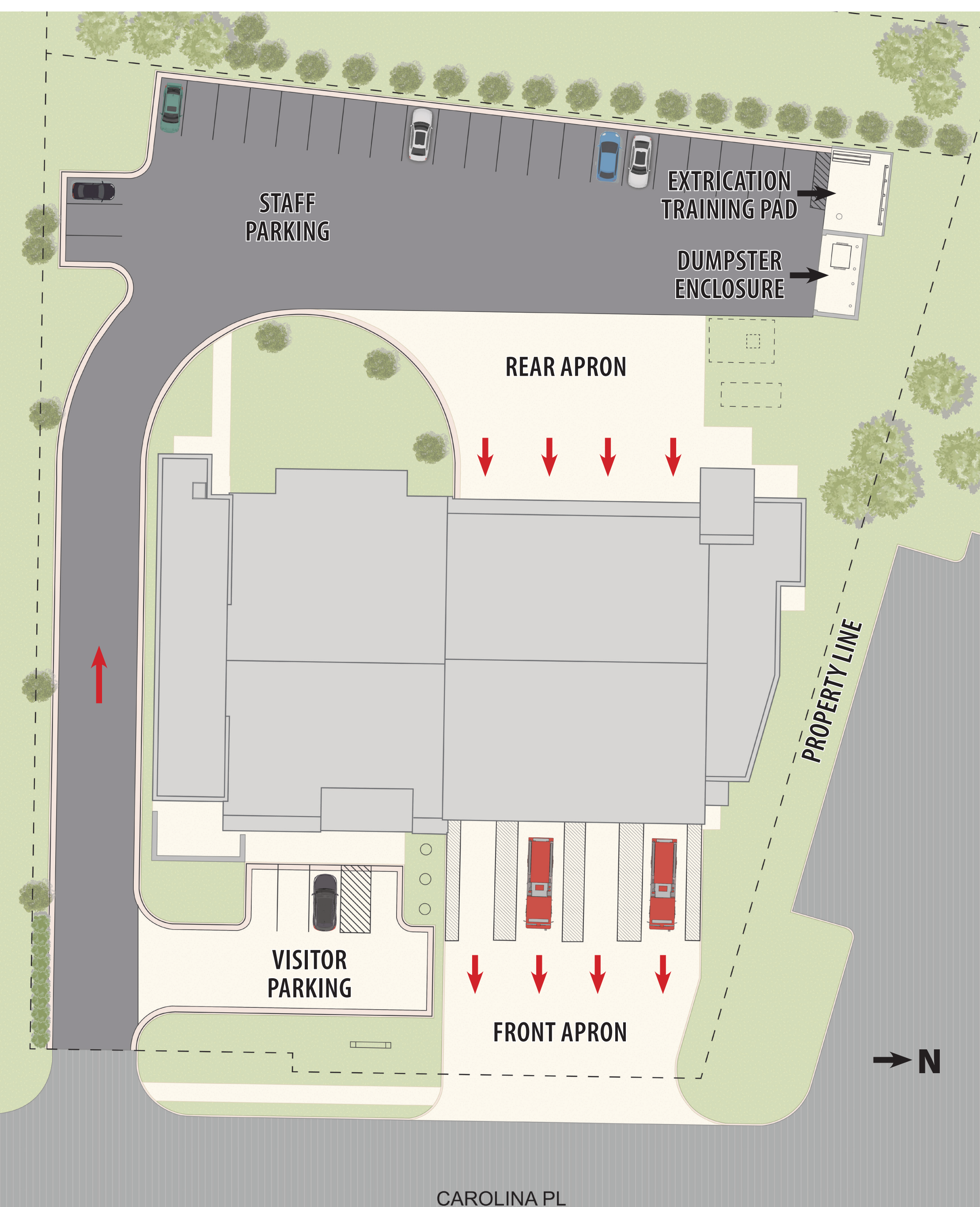

The renovation and addition was designed with a focus on operational performance and creating a healthy living environment. The final building design reduced energy usage, created a healthy indoor environment by specifying materials with limited to no off-gassing, and provided views and natural daylighting to all regularly occupied spaces. The renovated station utilized much of the infrastructure of the original station for cost savings and environmental stewardship and was awarded LEED Silver certification.



The core of the existing building, including the living and administrative spaces, was renovated while additions to the station supported the owner's full programming requirements. The additions included a training tower, kitchen, exercise room, ready gear, and decontamination space per the owner's program.